

CENTRIFUGAL PUMP MINI COMPASS

Mag drive centrifugal pump
made of thermoplastic material

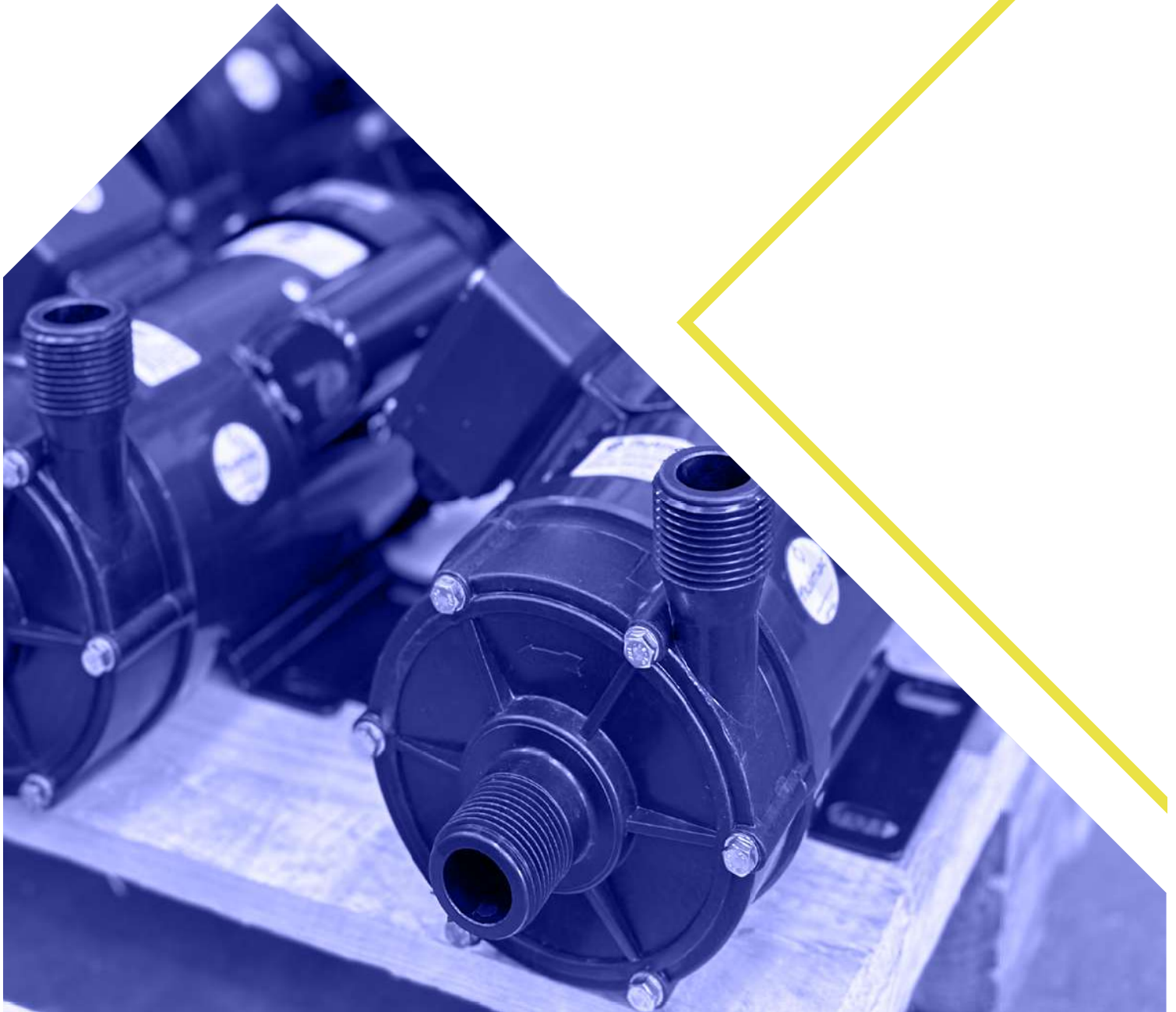

MINI COMPASS



Fluimac MINI COMPASS are single stage, centrifugal impeller and magnetic drive pumps. The range includes five models to deliver flows from 11 lt/min to 50 lt/min.

Compact dimension, low noise, absence of seals device makes the pumps ideal for application in any place or plant and can be incorporated into sophisticate equipment or "clean" environment. The Drive magnet, outside the casing and keyed on the spindle, drives the magnetic impeller inside the hermetic casing. In this way, the traditional shaft seal and the consequent leakage problems are eliminated. So, there is no corrosion of the outer parts (motor and bearings) in the environment.

MAIN FEATURES

- Casing and impeller in PP and PVDF
- O-ring in EPDM and VITON
- Shaft/Bearing in ALLUMINA 99,7%+PTFEC
- Max Flowrate: 50 lt/min
- Max Delivery Head: 8mt
- Temperature from -5°C to +90°C
- Max Viscosity: 20cps
- Electric Motors from 6W to 65W
- Max density: 1,1

INSTALLATION



POSITIVE SUCTION

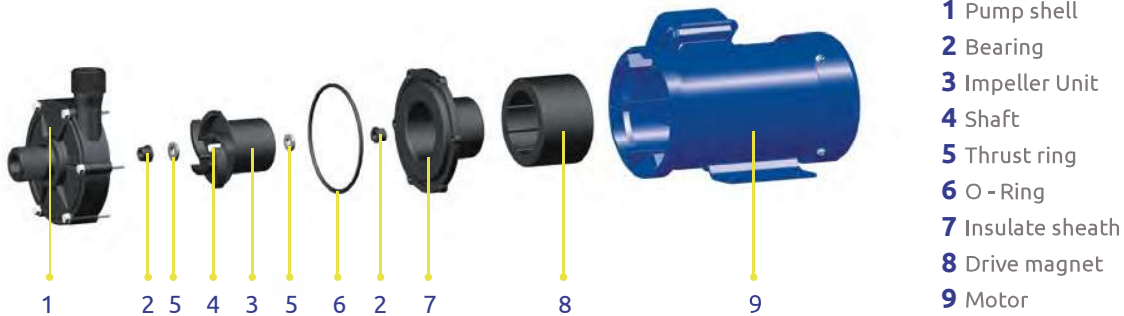

- 1 Pump shell
- 2 Bearing
- 3 Impeller Unit
- 4 Shaft
- 5 Thrust ring
- 6 O - Ring
- 7 Insulate sheath
- 8 Drive magnet
- 9 Motor

MOTOR FEATURES

MODEL	POWER	VOLTAGE	FREQUENCY	PROTECTION
MC 10	6W	220/240V	50/60Hz	IP54
MC 20	20W	220/240V	50/60Hz	IP54
MC 30	45W	220/240V	50/60Hz	IP54
MC 30 H	45W	220/240V	50/60Hz	IP54
MC 40	65W	220/240V	50/60Hz	IP54

MINI COMPASS



MC 10



MC 20



MC 30



MC 30H



MC 40

PERFORMANCE

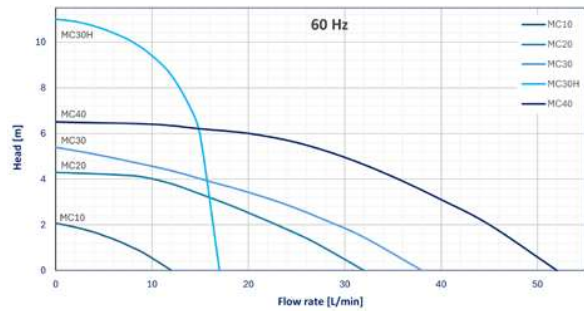
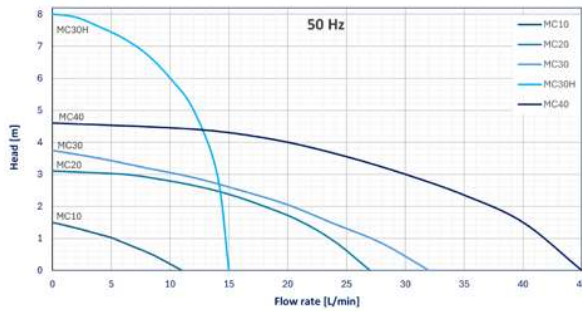

DIMENSIONS

	W	H	L	a	b	c	d	e	f	g	i	in/out	Weight
MC 10	74	83	129	-	30	60	36	31	17	74	2-ø6	14mm	0.9 kg
MC 20	85	115	211	30	50	68	56	38.5	28.5	106	5.5x10	3/4"	1.9 kg
MC 30	120	130	248	40	64	100	60	48	31	131	4-ø9	3/4"	3.1 kg
MC 30H	120	130	234	40	64	100	60	40	40	120	4-ø9	3/4"	3.1 kg
MC40	120	134	260	45	75	100	64	31	48	137	4.9x14	3/4"	3.8 kg

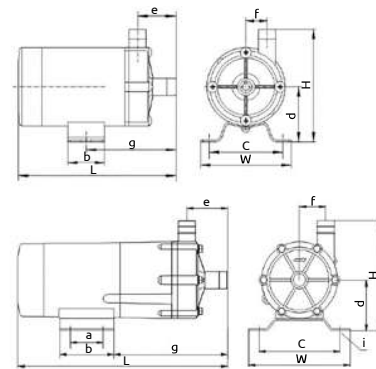

COMPOSITION

MODEL	CASING	O-RING	SHAFT+ BUSHING	MOTOR	MOTOR POWER
MC 10					S06 = 6w
MC 20	P = PP	D = EPDM	TA = PTFE +		S20 = 20w
MC 30	K = PVDF	V = VITON	ALLUMINIO 99.7%	1P = 1PH	S45 = 45w
MC 30 H					S45 = 45w
MC 40					S65 = 65w

COMPASS CENTRIFUGAL PUMPS

Thermoplastic Magnetic drive centrifugal pumps



COMPASS SERIES



The separation of liquid chamber/atmosphere by means of an isolation shell is the best solution to pump aggressive chemical, high purity liquids and liquids difficult to seal. Hermetic seal-less injection moulded thermoplastic pumps are the best solution for light duty applications. Mag driven centrifugal pumps series COMPASS are made of Polypropylene and PVDF and are suitable for high corrosive liquids. Thanks to the innovative mag drive system, COMPASS series reduce the risks of leakage and emissions and the maintenance costs. The transmission of the motion occurs through magnetic joints without any mechanical seal, and this design guarantees the maximum safety and efficiency. The pumped liquid must be clean and without solids in suspension.

MAIN FEATURES

- Casing and impeller in PP/PVDF
- O-ring in EPDM and VITON
- ALLUMINA + PTFEC 99,7% (standard)
- Max flow: 35 m³/h; Max head 25 mts
- Temperature: from -5 °C to +90°C
- Max viscosity: 200 CPS
- Max system pressure: 5 bar
- Electric motors from 0,12Kw up to 4Kw

INSTALLATION



POSITIVE SUCTION

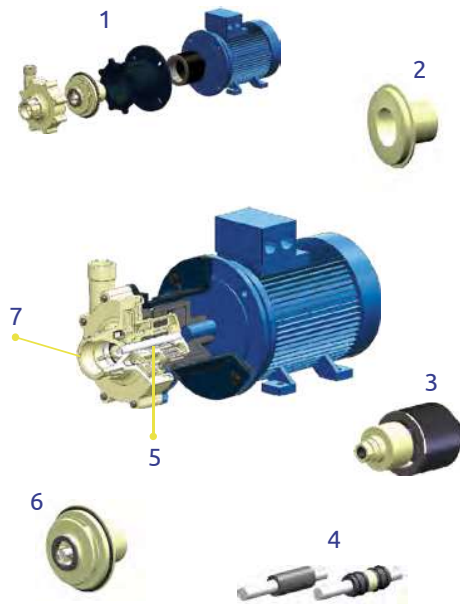

- 1 Few components (extremely easy maintenance), competitive prices, guaranteed chemical compatibility
- 2 The rear shell is made of thermoplastic materials, ellipsoidal profile, zero magnetic losses, GFR PP or CFR PVDF materials
- 3 High power synchronous magnetic coupling designed by our Technical Office and with magnetic elements mechanically locked. Rare earth guarantees the magnetic balancing to avoid the thrust bearings wear and the heat generation
- 4 Field assembling of the product lubricated bearing arrangement does not require special tools. The Shaft / Bearing materials are available in two different configurations to provide the best solution for each application:
 - PTFEC – ALLUMINA 99,7% (standard)
 - CARBON – ALLUMINA 99,7%
- 5 The sealing system with O-Rings prevents from leaking in the atmosphere – different materials available:
 - EPDM
 - VITON®
- 6 RWP QUICK CHANGE CARTRIDGE KIT to guarantee an easy and fast maintenance, materials PP and PVDF
- 7 Pump casing shall be one single piece, injection moulded designs, made of GFR PP and CFR PVDF

COMPASS SERIES

CM 4



TECHNICAL DATA

- Inlet connections 1" F
- Outlet connections 1/2" M
- Max. Flow rate 3,5 m³/h
- Max. Delivery head 7,5 m
- Max Viscosity 100 CPS
- Temperature PP -5°C +65°C
- Temperature PVDF -10°C +90°C
- Impeller Semi-Opened

PERFORMANCE

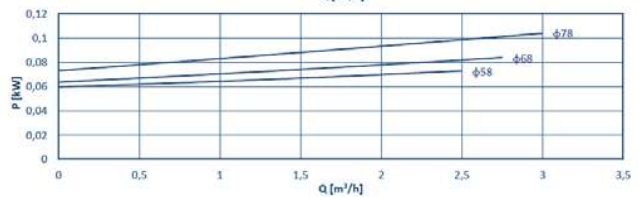
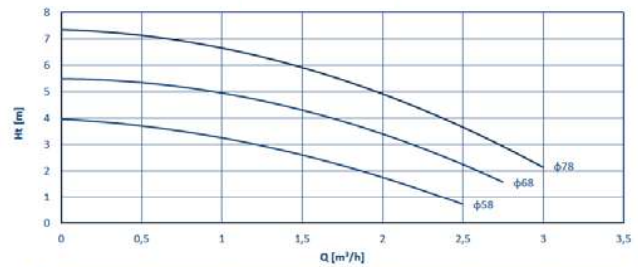

The curves and performance values refer to pumps with free delivery outlet with water at 20 °C, and two poles motor 50 Hz. These data may vary according to the construction materials and hydraulic conditions.

SPECIFIC GRAVITY TABLE

IMPELLER	0.12 KW
∅ 78 mm	Up to 1,1
∅ 68 mm	Up to 1,3
∅ 58 mm	Up to 1,5

MOTOR SPECIFICATION

Size	IEC 56
kw	0.12
RPM	2 poles 2900

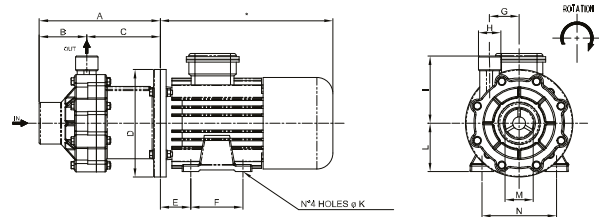

A	B	C	D	E	F	G	H	I	L	M	N	K
114	38.5	75.5	120	36	71	34	1/2"	80	56	1"	90	5.8

* It depends on the manufacturer

COMPOSITION

MODEL	CASING	O-RING	BUSHING+SHAFT	INPELLER	CONNECTIONS	MOTOR VERSION
CM04	P = PP	D = EPDM	TA = PTFEC + ALLUMINA 99,7%	78 = ∅ 78 mm STD	1 = BSP STD 2 = FLANGED	IE = IEC FLANGE
	K = PVDF	V = VITON		68 = ∅ 68 mm 58 = ∅ 58 mm		

COMPASS SERIES

CM 6



TECHNICAL DATA

- Inlet connections 1" F
- Outlet connections 3/4" M
- Max. Flow rate 7 m³/h
- Max. Delivery head 8,5 m
- Max Viscosity 150 CPS
- Temperature PP -5°C +65°C
- Temperature PVDF -10°C +90°C
- Impeller Closed

PERFORMANCE

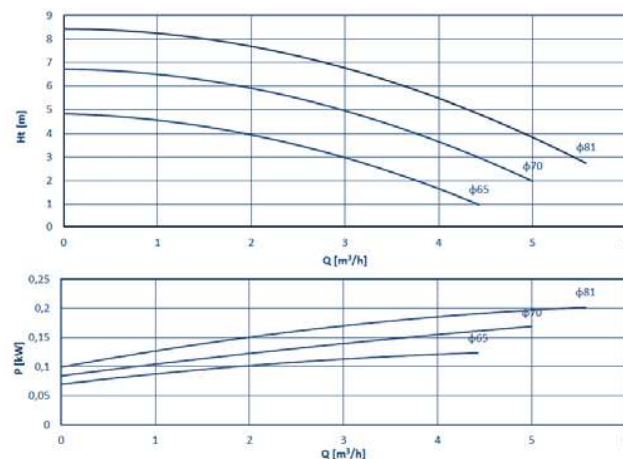

The curves and performance values refer to pumps with free delivery outlet with water at 20 °C, and two poles motor 50 Hz. These data may vary according to the construction materials and hydraulic conditions.

SPECIFIC GRAVITY TABLE

IMPELLER	0.25 KW	0.37 KW
∅ 81 mm	Up to 1,1	Up to 1,5
∅ 70 mm	Up to 1,3	Up to 1,8
∅ 65 mm	Up to 1,5	Up to 2

MOTOR SPECIFICATION

Size	IEC 63
kw	0.25-0.37
RPM	2 poles 2900

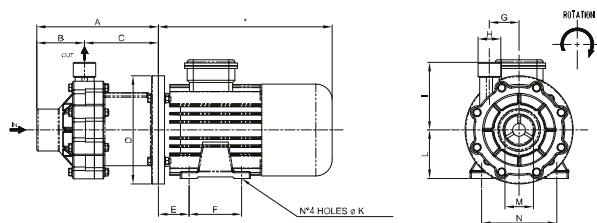

A	B	C	D	E	F	G	H	I	L	M	N	K
143	59	84	140	40	80	46	3/4"	91	63	1"	100	7

* It depends on the manufacturer

COMPOSITION

MODEL	CASING	O-RING	BUSHING+SHAFT	INPELLER	CONNECTIONS	MOTOR VERSION
CM06	P = PP	D = EPDM	TA = PTFEC + ALLUMINA 99,7%	81 = ∅ 81 mm STD	1 = BSP STD 2 = FLANGED	IE = IEC FLANGE
	K = PVDF	V = VITON		70 = ∅ 70 mm		
				65 = ∅ 65 mm		

COMPASS SERIES

CM 10



PP



PVDF

TECHNICAL DATA

- Inlet connections 1" 1/2 F
- Outlet connections 1" M
- Max. Flow rate 13 m³/h
- Max. Delivery head 14 m
- Max Viscosity 200 CPS
- Temperature PP -5°C +65°C
- Temperature PVDF -10°C +90°C
- Impeller Closed

PERFORMANCE

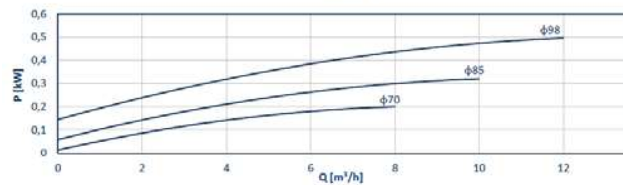
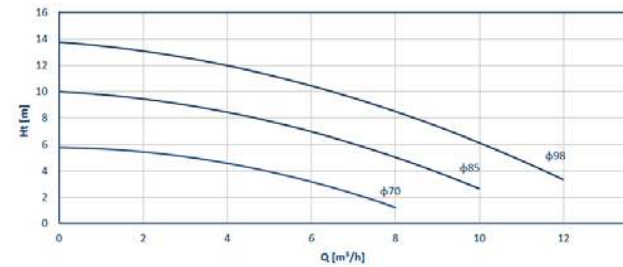

The curves and performance values refer to pumps with free delivery outlet with water at 20 °C, and two poles motor 50 Hz. These data may vary according to the construction materials and hydraulic conditions.

SPECIFIC GRAVITY TABLE

IMPELLER	0.55 KW	0.75 KW
∅ 98 mm	Up to 1,1	Up to 1,3
∅ 85 mm	Up to 1,5	Up to 1,8
∅ 70 mm	Up to 1,8	Up to 2

MOTOR SPECIFICATION

Size	IEC 71
kw	0.55-0.75
RPM	2 poles 2900

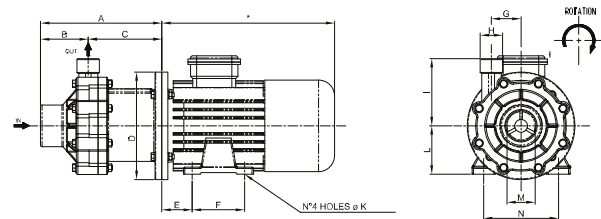

A B C D E F G H I L M N K

180 70.8 109.5 160 45 90 44 1" 100 71 1"1/2 112 7

* It depends on the manufacturer

COMPOSITION

MODEL	CASING	O-RING	BUSHING+SHAFT	INPELLER	CONNECTIONS	MOTOR VERSION
CM10	P = PP	D = EPDM	TA = PTFEC + ALLUMINA 99,7%	98 = ∅ 98 mm STD	1 = BSP STD 2 = FLANGED	IE = IEC FLANGE
	K = PVDF	V = VITON		85 = ∅ 85 mm 70 = ∅ 70 mm		

COMPASS SERIES

CM 15



TECHNICAL DATA

- Inlet connections 2" F
- Outlet connections 1" 1/4 M
- Max. Flow rate 23,5 m³/h
- Max. Delivery head 20 m
- Max Viscosity 200 CPS
- Temperature PP -5°C +65°C
- Temperature PVDF -10°C +90°C
- Impeller Closed

PERFORMANCE

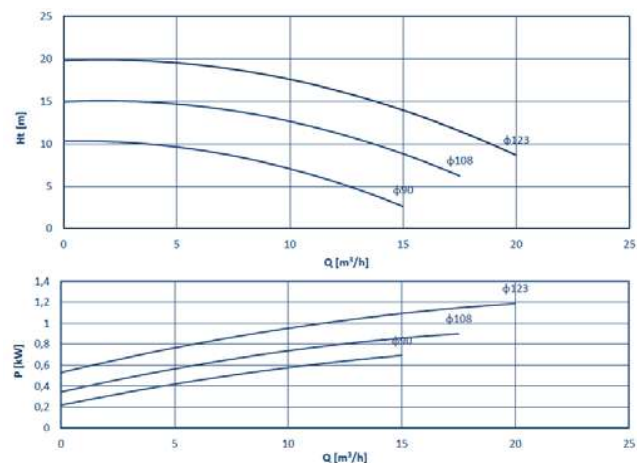

The curves and performance values refer to pumps with free delivery outlet with water at 20 °C, and two poles motor 50 Hz. These data may vary according to the construction materials and hydraulic conditions.

SPECIFIC GRAVITY TABLE

IMPELLER	1.1 KW	1.5 KW
∅ 123 mm	Up to 1	Up to 1,1
∅ 108 mm	Up to 1,2	Up to 1,5
∅ 90 mm	Up to 1,5	Up to 1,8

MOTOR SPECIFICATION

Size	IEC 80
kw	1.1-1.5
RPM	2 poles 2900

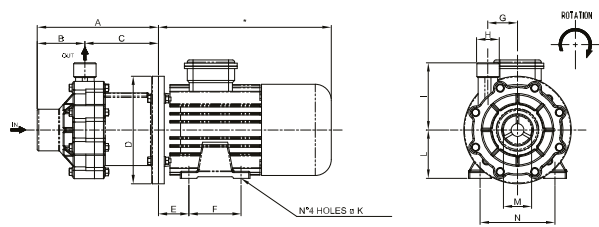

A	B	C	D	E	F	G	H	I	L	M	N	K
231	81	150	200	50	100	62.5	1"-1/4	125	80	2"	125	9.5

* It depends on the manufacturer

COMPOSITION

MODEL	CASING	O-RING	BUSHING+SHAFT	INPELLER	CONNECTIONS	MOTOR VERSION
CM15	P = PP	D = EPDM	TA = PTFEC + ALLUMINA 99,7%	123 = ∅ 123 mm STD	1 = BSP STD 2 = FLANGED	IE = IEC FLANGE
	K = PVDF	V = VITON		108 = ∅ 108 mm 90 = ∅ 90 mm		

COMPASS SERIES

CM 30



PP



PVDF

TECHNICAL DATA

- Inlet connections 2" F
- Outlet connections 1" 1/2 M
- Max. Flow rate 35 m³/h
- Max. Delivery head 24 m
- Max Viscosity 200 CPS
- Temperature PP -5°C +65°C
- Temperature PVDF -10°C +90°C
- Impeller Closed

PERFORMANCE

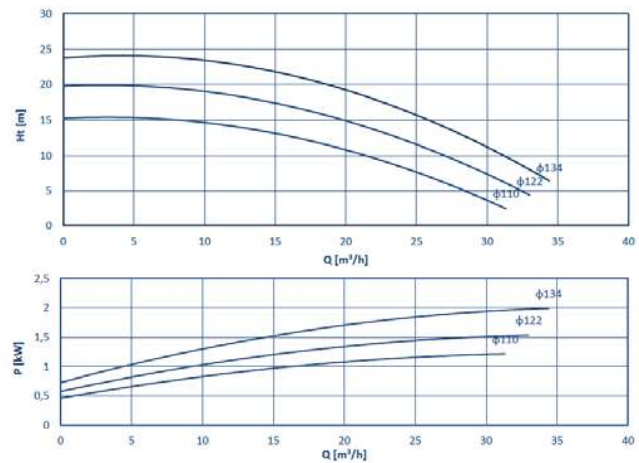

The curves and performance values refer to pumps with free delivery outlet with water at 20 °C, and two poles motor 50 Hz. These data may vary according to the construction materials and hydraulic conditions.

SPECIFIC GRAVITY TABLE

IMPELLER	2.2 KW	3 KW
∅ 134 mm	Up to 1,1	Up to 1,3
∅ 122 mm	Up to 1,3	Up to 1,5
∅ 110 mm	Up to 1,8	Up to 2

MOTOR SPECIFICATION

Size	IEC 90
kw	2.2-3
RPM	2 poles 2900

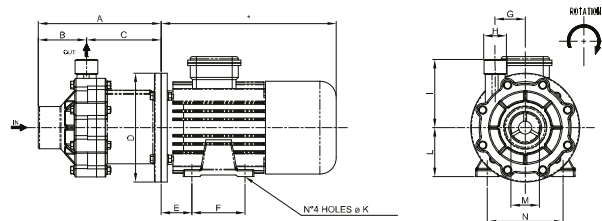

A	B	C	D	E	F	G	H	I	L	M	N	K
278	91	187	200	56	100	66.5	1-1/2"	140	90	2"	140	10

* It depends on the manufacturer

COMPOSITION

MODEL	CASING	O-RING	BUSHING+SHAFT	INPELLER	CONNECTIONS	MOTOR VERSION
CM30	P = PP	D = EPDM	TA = PTFEC + ALLUMINA 99,7%	134 = ∅ 134 mm STD	1 = BSP STD 2 = FLANGED	IE = IEC FLANGE
	K = PVDF	V = VITON		122 = ∅ 122 mm		
				110 = ∅ 110 mm		